

REVISIONS			
REV		DATE	APPROVED

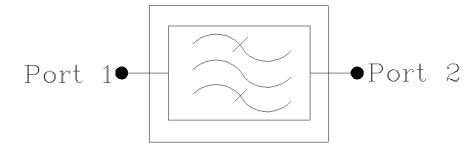
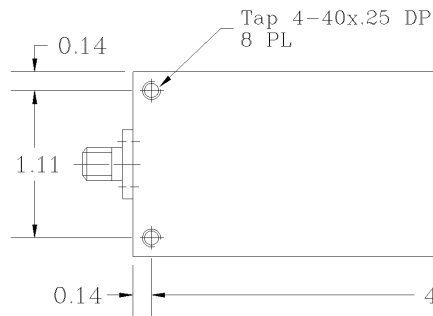
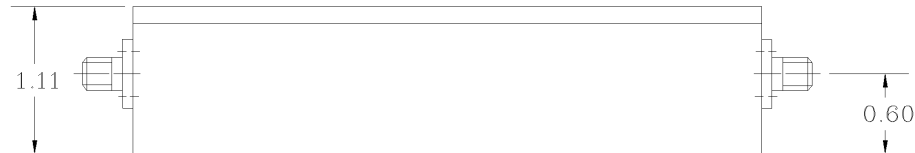
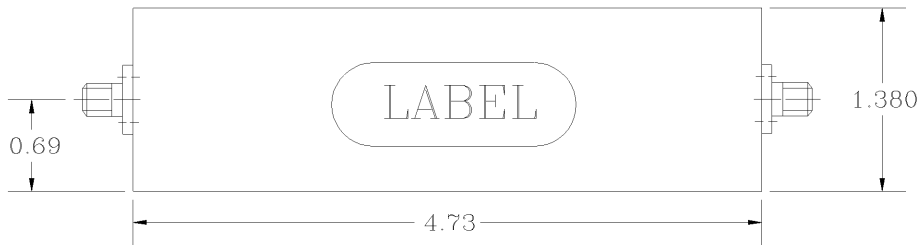
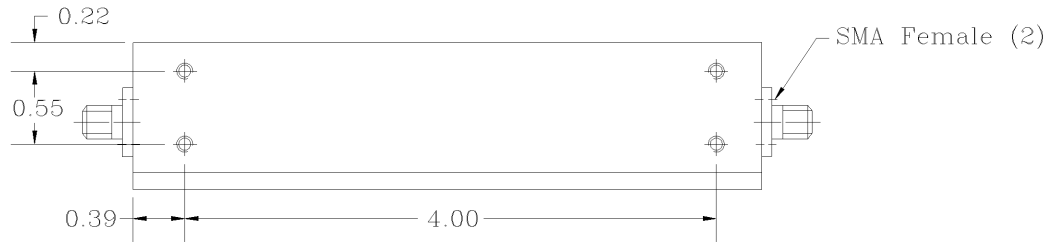

Electrical Specifications

- *1dB Pass Band Frequency Range [MHz] : 68 to 119
- *Pass Band Insertion Loss @ Fo [dB] : < 1.5
- *Pass Band Ripple [dB] : < 0.5 P-T-P
- *Attenuation @ DC to 56 MHz [dB] : 20 (Min.)
- *Attenuation @ 131 to 250 MHz [dB] : 20 (Min.)
- *Pass Band Return Loss [dB] : < 1.5:1
- *Input/Output Impedance : 50 ohm
- *Input/Output @ DC Ground Potential
- *RF Power Capability Average : 1 Watt

OPERATING TEMPERATURE RANGE: -10°C TO +50°C

PROPRIETARY DOCUMENT:
THE CONTENTS OF THIS DOCUMENT WITH ALL INFORMATION AND PROCESSES ARE THE SOLE PROPERTY OF G-Way Microwave. THIS DOCUMENT MAY NOT BE DUPLICATED OR DISCLOSED TO ANY PARTY EXCEPT BY EXPRESSLY WRITTEN PERMISSION. THE ONLY AUTHORIZED USE OF THIS DOCUMENT BY A VENDOR IS FOR QUOTE PURPOSES AND SAID VENDOR AGREES NOT TO DISCLOSE ITS CONTENTS TO ANY THIRD PARTY. THIS DOCUMENT IS COPYRIGHTED 1998.

NOTES:

1. BREAK ALL CORNERS & EDGES.005/ .010.
2. FINAL FINISH:
EPOXY GRAY - OPTIONAL

DIMENSIONS ARE IN INCHES: TOLERANCES ARE		CONTRACT NO:		G-Way Microwave			
ANGLES	DECIMALS	APPROVALS	DATE				
± 1°	.X ± .05 .XX ± .01 .XXX ± .003	DRAWN Sivak	05/11	LB93.5/510K-A		REV.	0
TREATMENT		CHECKED		SIZE	CAGE CODE	DWG NO:	
FINISH	63/	ENG.		A	3K1H4	LB93.5/510K-A-1	
MATERIAL	AL6061-T6	DESIGN ACTIVITY		SCALE	None		SHEET 1 OF 1

LBB.5/510K-A

8 Aug 2014 13:48:00
 CH1 S21 LOG 10 dB/REF 0 dB 5: -74.013 dB 250.000 000 MHz
 CH2 S11 LOG 5 dB/REF -17 dB 5: -0.7820 dB

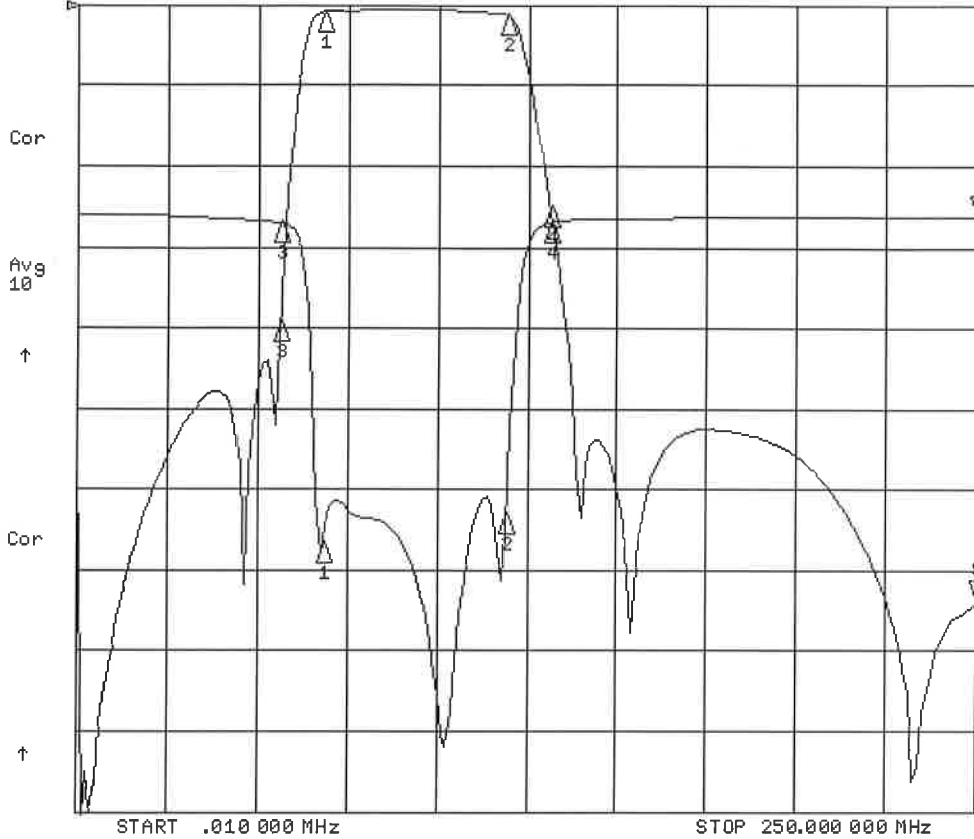

CH1 Markers

- 1: -80.000 dB
68.000 MHz
- 2: -1.2864 dB
119.000 MHz
- 3: -39.219 dB
56.000 MHz
- 4: -25.067 dB
131.000 MHz

CH2 Markers

- 1: -20.287 dB
68.000 MHz
- 2: -18.473 dB
119.000 MHz
- 3: -53.440 dB
56.000 MHz
- 4: -46.580 dB
131.000 MHz

8 Aug 2014 13:48:08
 CH1 S21 LOG 1 dB/REF 0 dB 5: -.54510 dB 93.500 000 MHz
 CH2 S11 LOG 5 dB/REF -17 dB 5: -22.049 dB

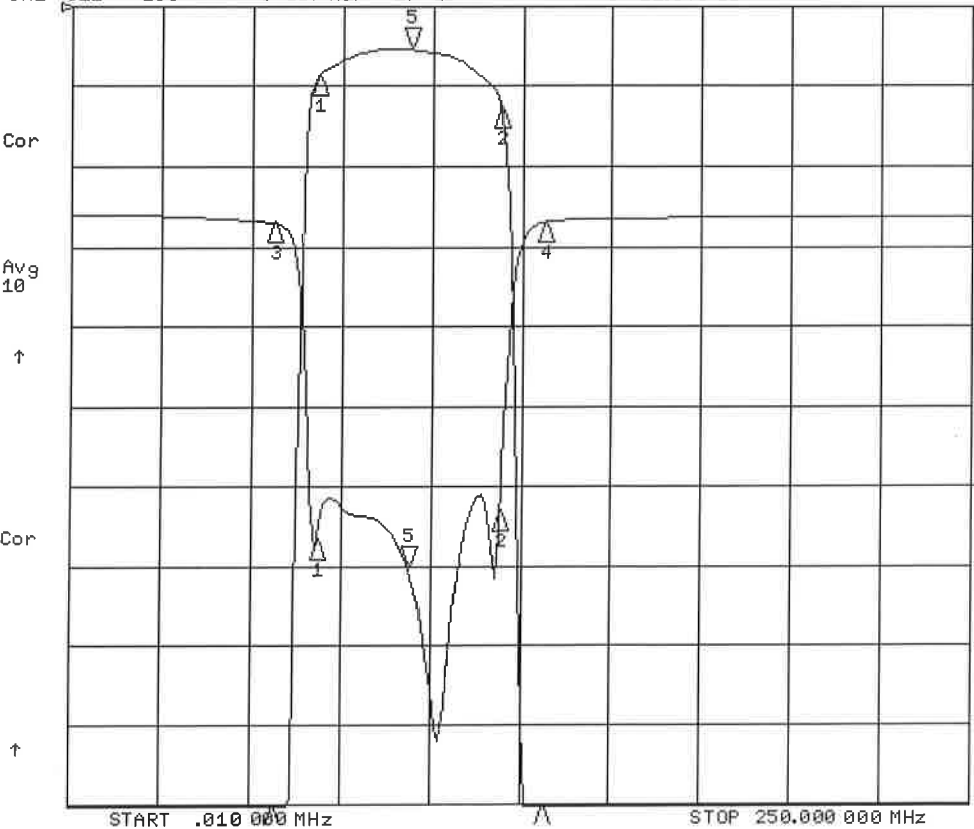

CH1 Markers

- 1: -80.000 dB
68.000 MHz
- 2: -1.2872 dB
119.000 MHz
- 3: -39.211 dB
56.000 MHz
- 4: -25.070 dB
131.000 MHz

CH2 Markers

- 1: -20.289 dB
68.000 MHz
- 2: -18.465 dB
119.000 MHz
- 3: -53.440 dB
56.000 MHz
- 4: -46.600 dB
131.000 MHz