

REVISIONS			
REV		DATE	APPROVED
A	Connector location adjusted.	10/06	G. David
B	Add and Change mount holes.	02/07	Greg

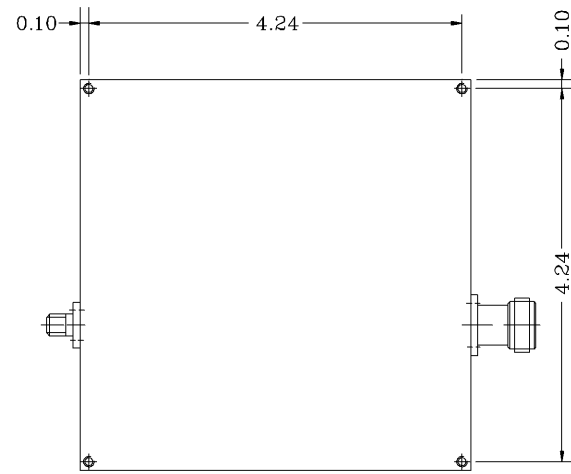

Tap 4-40X0.250 DP 4 PL

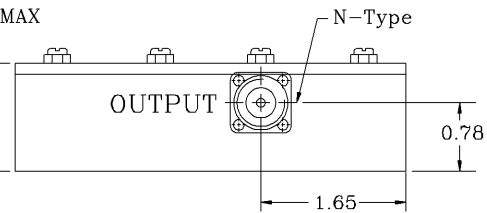
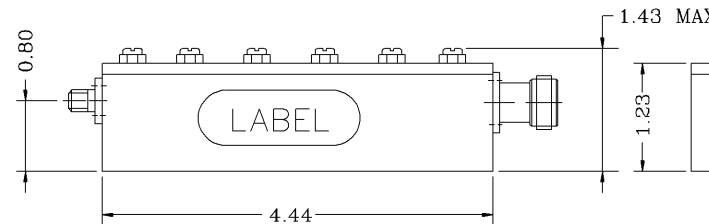
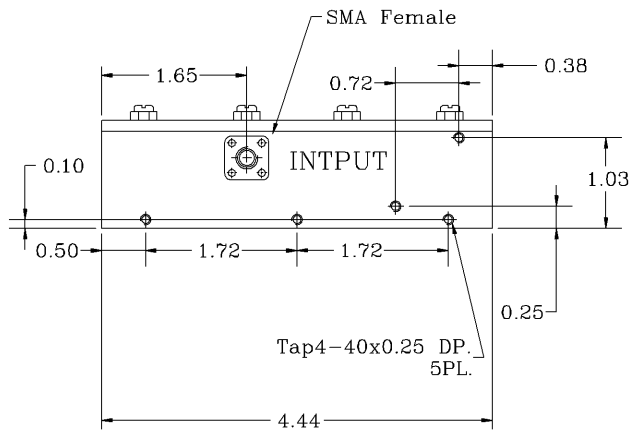
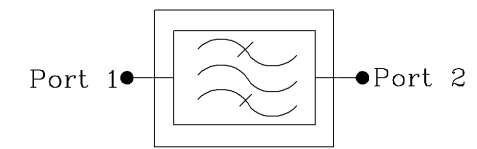

### Electrical Specifications

- \*1dB Pass Band Range [MHz] : 1700 to 2000
- \*Pass Band Insertion Loss [dB] : <0.7
- \*Pass Band Ripple [dB] : <0.4 P-T-P
- \*Rejection DC to 1644 MHz [dB] : 70 (Min.), 75 (Typ.)
- @ 2150 to 6000 MHz [dB] : 70 (Min.)
- \*Pass Band Return Loss [dB] : -16 (Max.), <1.38:1
- \*Input/Output Impedance : 50 ohm
- \*RF Power Capability CW : 5 Watts
- \*Input/Output @ DC Ground Potential

OPERATING TEMPERATURE RANGE: -30°C TO +85°C

PROPRIETARY DOCUMENT:  
 THE CONTENTS OF THIS DOCUMENT WITH ALL INFORMATION AND PROCESSES ARE THE SOLE PROPERTY OF G-Way Microwave. THIS DOCUMENT MAY NOT BE DUPLICATED OR DISCLOSED TO ANY PARTY EXCEPT BY EXPRESSLY WRITTEN PERMISSION. THE ONLY AUTHORIZED USE OF THIS DOCUMENT BY A VENDOR IS FOR QUOTE PURPOSES AND SAID VENDOR AGREES NOT TO DISCLOSE ITS CONTENTS TO ANY THIRD PARTY. THIS DOCUMENT IS COPYRIGHTED 1998.

- NOTES:
- BREAK ALL CORNERS & EDGES.005/.010.
  - FINAL FINISH:  
EPOXY GRAY - OPTIONAL

DIMENSIONS ARE IN INCHES TOLERANCES ARE:		CONTRACT NO:		<b>G-Way Microwave</b>					
ANGLES	DECIMALS	APPROVALS	DATE					TITLE Band Pass Filter 1700-2000 MHz	
± 1°	.X ± .05 .XX ± .01 .XXX ± .003	DRAWN Sivak	02/07	CB1850/300SK-D2		SIZE	CAGE CODE	DWG NO:	REV.
TREATMENT		CHECKED		A	3K1H4	CB1850/300SK-D2-1	B		
FINISH	63/	ENG.		SCALE None		SHEET 1		OF 1	
MATERIAL	AL6061-T6	DESIGN ACTIVITY							

CB1850/300SK-D2  
SN: 06091001

20 Sep 2006 15:31:21

CH1 S21 LOG 10 dB/REF 0 dB 5: -42.900 dB 1.850 000 000 GHz  
CH2 S11 LOG 5 dB/REF -16 dB 5: -17.145 dB

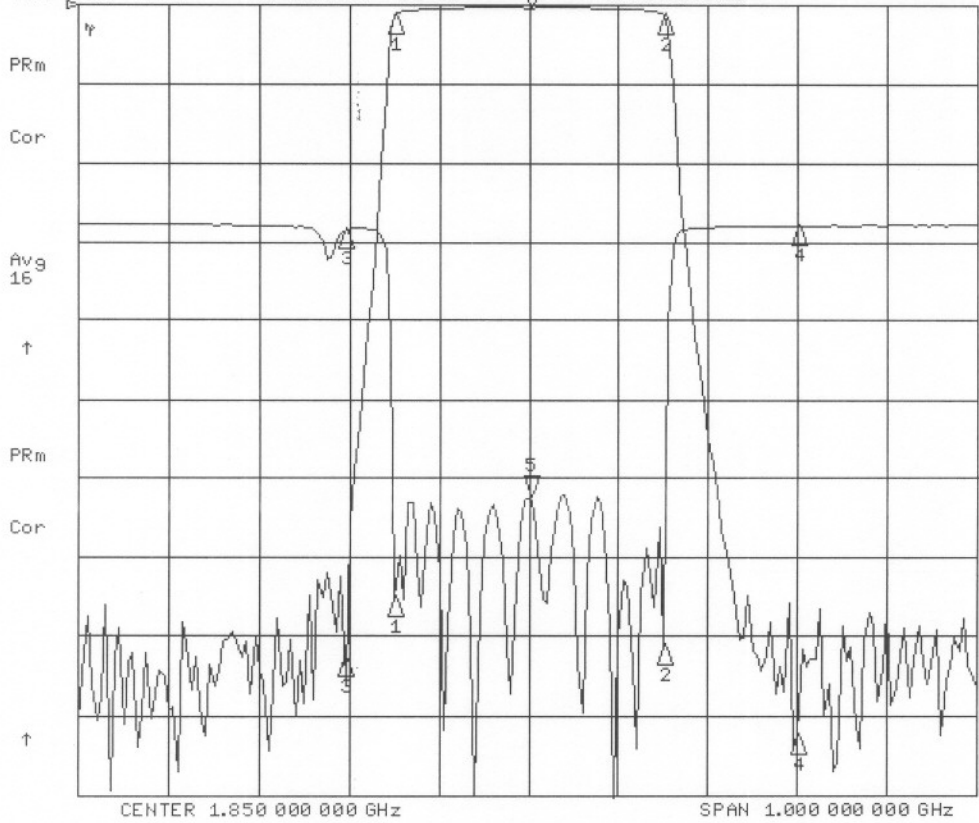

CH1 Markers

1: -1.1830 dB  
1.70000 GHz  
2: -1.1840 dB  
2.00000 GHz  
3: -82.489 dB  
1.64400 GHz  
4: -92.492 dB  
2.15000 GHz

CH2 Markers

1: -23.590 dB  
1.70000 GHz  
2: -26.537 dB  
2.00000 GHz  
3: -26.000 dB  
1.64400 GHz  
4: .06000 dB  
2.15000 GHz

20 Sep 2006 15:31:23

CH1 S21 LOG 1 dB/REF 0 dB 5: -43.000 dB 1.850 000 000 GHz  
CH2 S11 LOG 5 dB/REF -16 dB 5: -17.133 dB

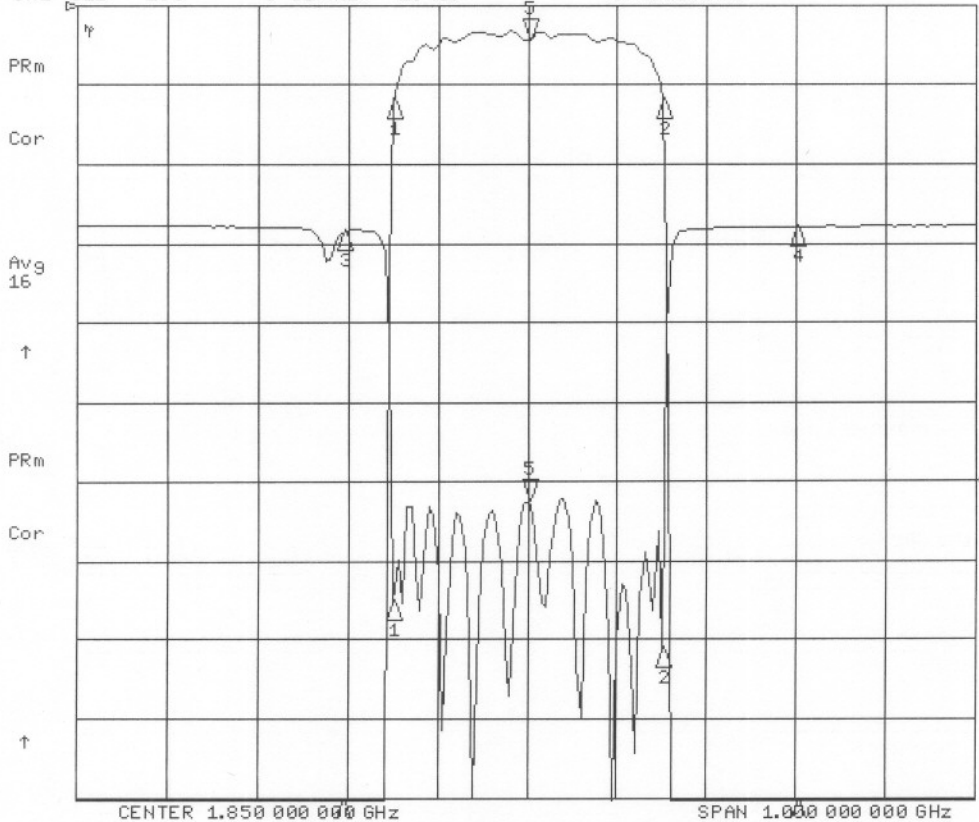

CH1 Markers

1: -1.1820 dB  
1.70000 GHz  
2: -1.1840 dB  
2.00000 GHz  
3: -82.708 dB  
1.64400 GHz  
4: -89.009 dB  
2.15000 GHz

CH2 Markers

1: -23.582 dB  
1.70000 GHz  
2: -26.520 dB  
2.00000 GHz  
3: -26.700 dB  
1.64400 GHz  
4: .06000 dB  
2.15000 GHz