

REVISIONS			
REV		DATE	APPROVED

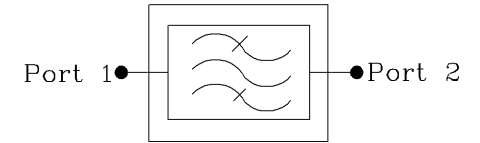
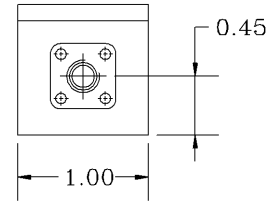
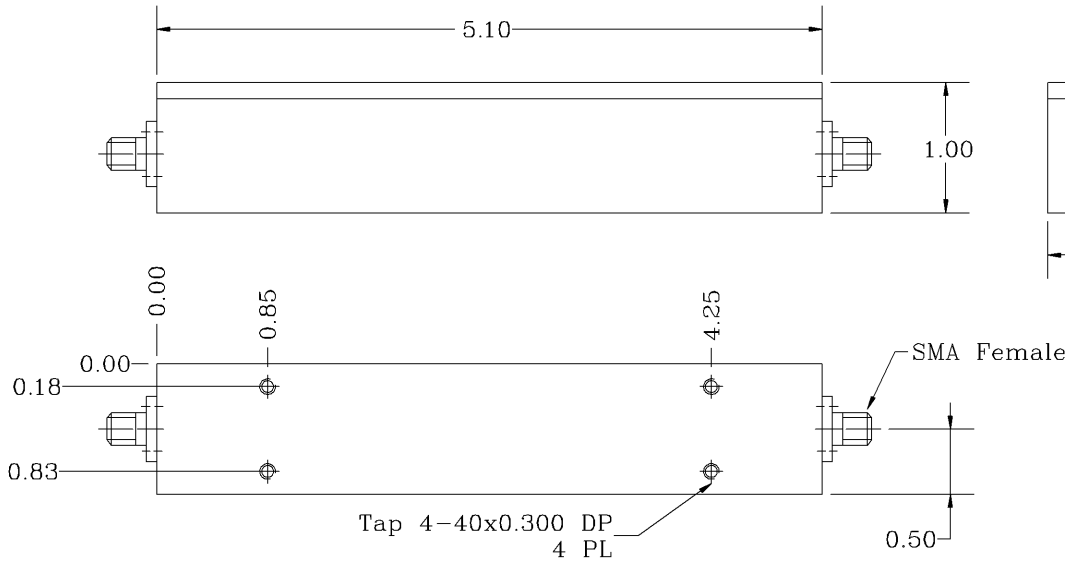

Electrical Specifications

- *Pass Band Frequency Range [MHz] : 3625 to 4200
- *Pass Band Insertion Loss (Including Ripple) [dB] : <0.6
- *Pass Band Ripple [dB] : <0.2 P-T-P
- *Attenuation DC to 3185 MHz [dB] : 60 (Min.), 65 (Typ.)
- @ 4550 to 11000 MHz [dB] : 60 (Min.)
- *Ultimate Stop Band Attenuation [dB] : 80 (Min.)
- *Pass Band Return Loss [dB] : -17 (Max.), <1.33:1
- *Input/Output Impedance : 50 ohm
- *RF Power Capability CW : 10 Watts
- *Input/Output @ DC Ground Potential

OPERATING TEMPERATURE RANGE: -35°C TO +75°C

PROPRIETARY DOCUMENT:
 THE CONTENTS OF THIS DOCUMENT WITH ALL INFORMATION AND PROCESSES ARE THE SOLE PROPERTY OF G-Way Microwave. THIS DOCUMENT MAY NOT BE DUPLICATED OR DISCLOSED TO ANY PARTY EXCEPT BY EXPRESSLY WRITTEN PERMISSION. THE ONLY AUTHORIZED USE OF THIS DOCUMENT BY A VENDOR IS FOR QUOTE PURPOSES AND SAID VENDOR AGREES NOT TO DISCLOSE ITS CONTENTS TO ANY THIRD PARTY. THIS DOCUMENT IS COPYRIGHTED 1998.

NOTES:

1. BREAK ALL CORNERS & EDGES.005/.010.
2. FINAL FINISH:
EPOXY GRAY - OPTIONAL

DIMENSIONS ARE IN INCHES TOLERANCES ARE		CONTRACT NO:		G-Way Microwave			
ANGLES	DECIMALS	APPROVALS	DATE				
± 1°	.X ± .05 .XX ± .01 .XXX ± .003	DRAWN Sivak	01/08	CB3912.5/575SK-A		REV.	0
TREATMENT	CHECKED	ENG.	DESIGN ACTIVITY	SIZE	CAGE CODE	DWG NO:	
FINISH 63/				A	3K1H4	CB3912.5/575SK-A-1	
MATERIAL AL6061-T6				SCALE None			SHEET 1 OF 1

CB3912.5/575 SK-A1

